

# BERTSCHenergy

Power plants  
Process equipment

95  
YEARS

TRADITION  
QUALITY  
KNOW-HOW  
SINCE 1925

## Combined Heat and Power Plant Daimler Sindelfingen

Reference Sheet



**BERTSCH**

TRADITION, QUALITY, KNOW-HOW. SINCE 1925

## »HRSG (Heat Recovery Steam Generator) downstream a GE LM 2500+ (30 MWeI) gas turbine – Commissioning 3<sup>rd</sup> quarter 2013«

This system provides the Daimler location in Sindelfingen with electricity as well as steam for production processes and ambient heating. In addition, the thermal energy is fed into the district heating network of the Stadtwerke Sindelfingen utility company.

As the manufacturer of a comprehensive system, BERTSCHEnergy's task was to integrate the customer-provided gas turbine including auxiliary equipment into the new power house that stands 44 m tall. The system features a number of specific characteristics, including the positioning of the boiler above the gas turbine to achieve maximum space-saving capability as well as strong secondary firing capacity. Special challenges during the installation of the system included the initial concept for the gas turbine and power house, the logistics during installation and the integration of all systems into the existing plant.

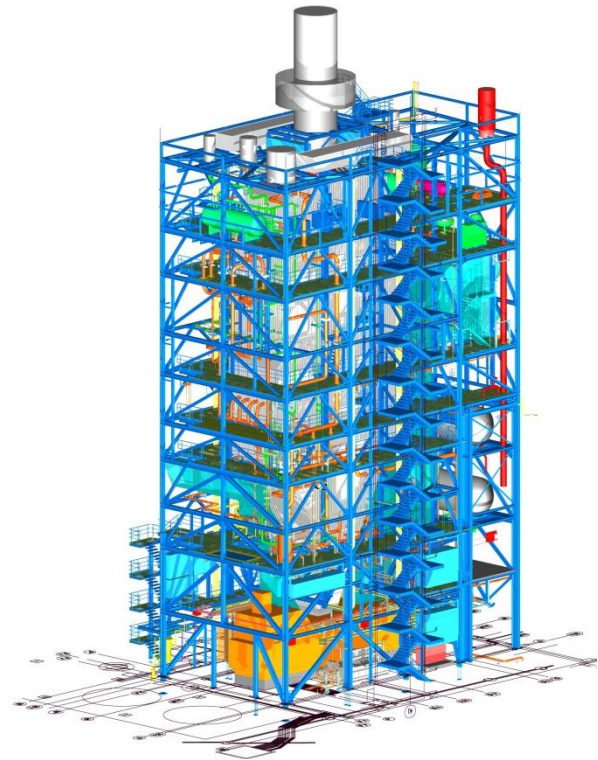

### TECHNICAL DATA

|                               |         |
|-------------------------------|---------|
| » Steam flow MCR (HP)         | 98 t/h  |
| » Steam flow MCR (LP)         | 9 t/h   |
| » S.H. steam pressure (HP)    | 120 bar |
| » S.H. steam pressure (LP)    | 16 bar  |
| » S.H. steam temperature (HP) | 530°C   |
| » S.H. steam temperature (LP) | 220°C   |
| » Flue gas flow               | 87 kg/s |
| » GT outlet temperature       | 515°C   |

### SCOPE OF SUPPLY

|  |
|--|
| » Disassembly of existing boiler   |
| » Maintenance of remaining steel structure   |
| » Foundation works, stair tower, buildings for gas compressor, transformer and E&C-systems |
| » Steel structure for boiler and boiler house  |
| » Facade and HVAC-systems for boiler house   |
| » Heat recovery steam generator  |
| » Burner   |
| » Piping   |
| » District heat system   |
| » Pumps  |
| » Electrical, I&C  |

