

BERTSCHenergy

Power Plants
Process Equipment

95
YEARS

TRADITION
QUALITY
KNOW-HOW
SINCE 1925

Mayr-Melnhof Karton Frohnleiten / AT

Reference Sheet



BERTSCH

TRADITION, QUALITY, KNOW-HOW. SINCE 1925.

» 34 MWel Combined Cycle Power Plant with a one boiler downstream two gas turbines design and full fresh air mode back up«

The CCPP is feeding the board mill with steam, electricity and heating water with a fuel utilization of 97% which is establishing a new benchmark. The plant is fulfilling latest environmental standards and is already designed to be upgraded for upcoming standards. Highest operation flexibility combined with the capability of supplying balancing energy to the grid is the basis for highest profitability of the plant. Situated in a noise protection zone the plant is designed to emit 89 dB(A) sound power only, which was achieved by special design of the equipment and its arrangement.

Bertsch Energy supplied the plant as a full turnkey project including all integration work into the customer's site.

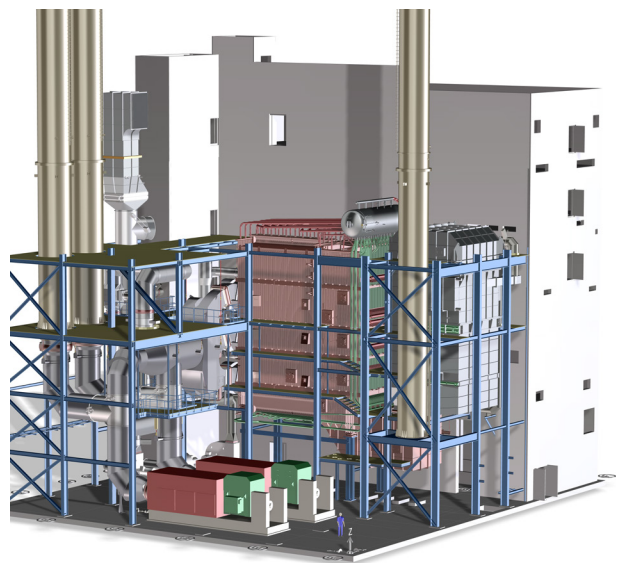

TECHNICAL DATA

» Gas turbine power output	2 x 7.6 MW
» Steam turbine power output	18.5 MW
» Steam flow (MCR)	120 t/h
» Steam pressure	70 bar (a)
» Steam temperature	490° C
» 100% fresh air firing possibility	

SCOPE OF SUPPLY

» Turn-key delivery incl. process connection
» Gas and steam turbines
» Heat recovery steam generator
» Electrical engineering and control works
» Construction works
» Building services
» Emergency diesel
» Gas transfer station

