

BERTSCHlaska

Machinery and equipment
for the food industry

95
JAHRE

TRADITION
QUALITÄT
KNOW-HOW
SEIT 1925

Meat and sausage production plant

HEILONG JING BOTAO FOOD, People's Republic of China



BERTSCH

TRADITION, QUALITY, KNOW-HOW. SINCE 1925

Meat and sausage production plant

Capacity: 30 tons per shift

Factory area: 4.500 m²

Project HEILONG JING BOTAO FOOD

PROJECT PLANNING (GREEN FIELD)

- » Project study
- » Technological project planning
- » Continuous project support

SCOPE OF DELIVERY (EQUIPMENT)

- » RAILWAY TECHNOLOGY
 - Defrosting room
 - Cold-storage rooms for cattle and pig carcasses
 - Railway technology at loading and deboning area
- » DELICACIES PREPARATION
 - Injector, Vacuum tumbler, etc.
- » SAUSAGE PRODUCTION
 - Scale ice machine, angle mincer, cutter, mixing machine, etc.
- » THERMAL SECTION
 - Smoke, cooking, roasting, intensive cooling and post-maturing systems
- » HYGIENIC EQUIPMENT
 - Hygiene locks, knife steriliser , etc.

INSTALLATION AND COMMISSIONING

- » Chef assembly including technological process support
- » Technical and technological personnel training

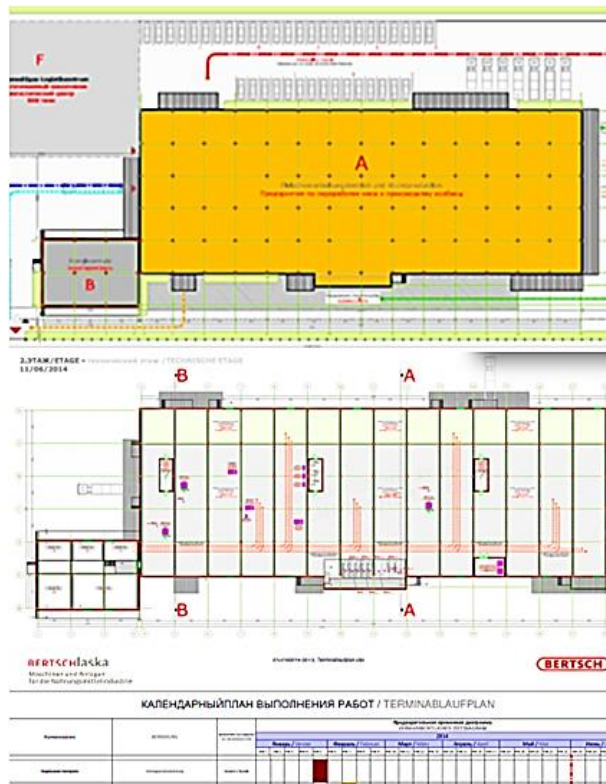

Layout



Sausage production



Refrigeration systems



Thermal section